

GBC[®]

INSPIRE™ PLUS

A4 & A3 LAMINATORS

塑封机

Instruction Manual
使用说明书



USE
ORIGINAL
GBC SUPPLIES

Performance
Guaranteed

www.accobrand.com

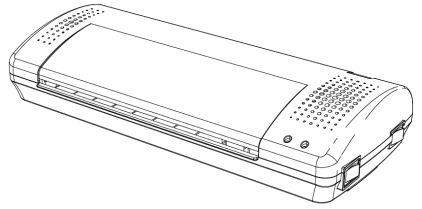

INSPIRE™ PLUS A4 & A3

Contents

• Important Information

- ▶ Introduction 5
- ▶ Technical Specifications 5
- ▶ Points to Note 5

• Function

- ▶ Operation, hot lamination 6
- ▶ Operation, cold lamination 6
- ▶ Release Button 6

• Maintenance & Warranty

- ▶ Cleaning 6
- ▶ Laminating Tips 7
- ▶ Service 7
- ▶ Guarantee 7

目录

• 重要信息

- ▶ 产品简介 8
- ▶ 规格参数 8
- ▶ 警告 8

• 功能

- ▶ 操作：热封 9
- ▶ 操作：冷裱 9
- ▶ 清除卡纸 9

• 保养和保修

- ▶ 清理清洁 9
- ▶ 塑封小贴士 10
- ▶ 维修服务 10
- ▶ 保证 10

Plus A4

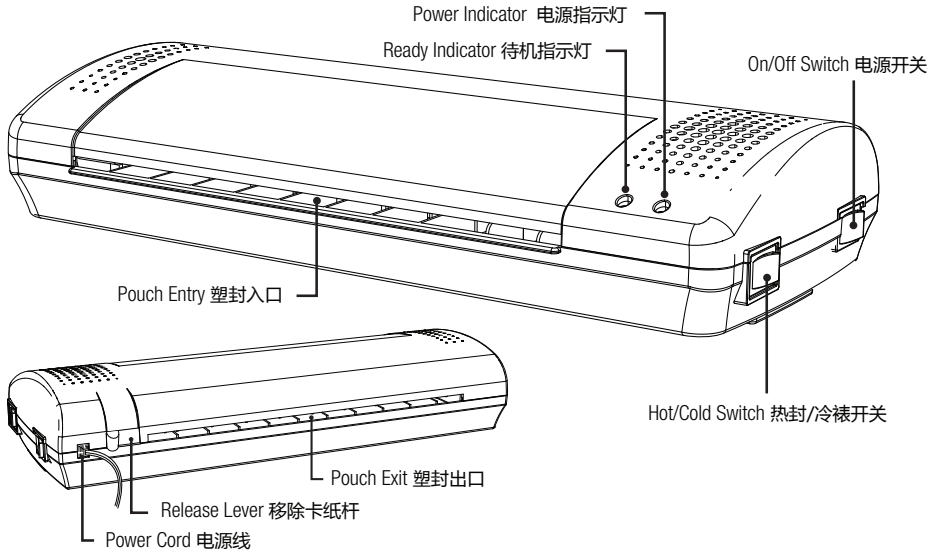

Plus A3

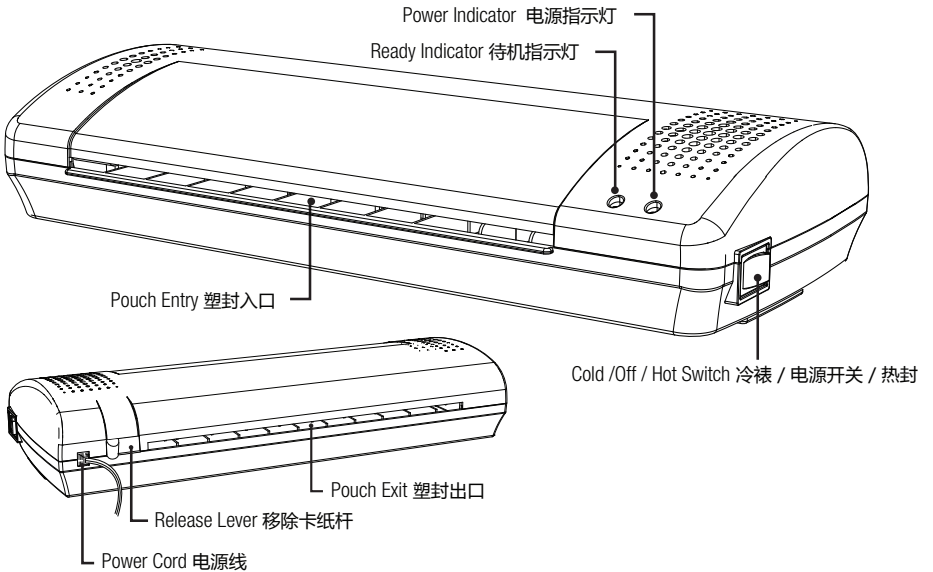

Plus A4

Plus A3

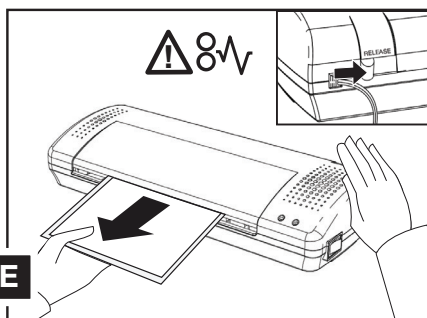
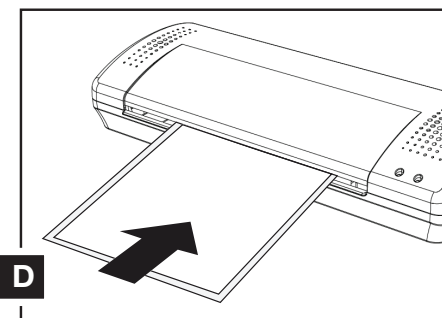
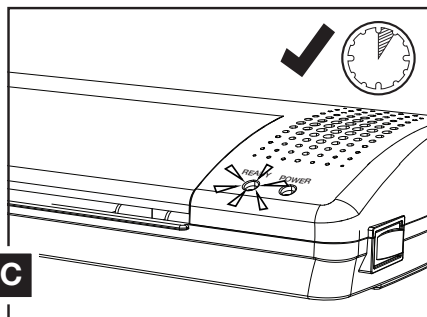
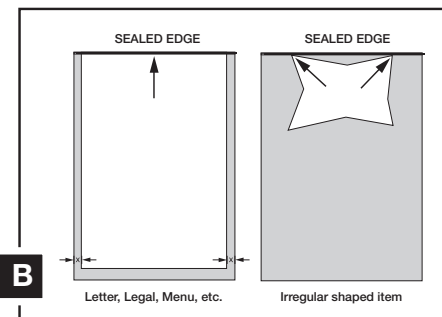
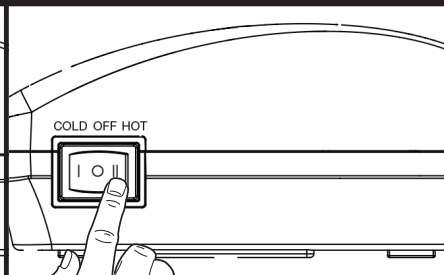
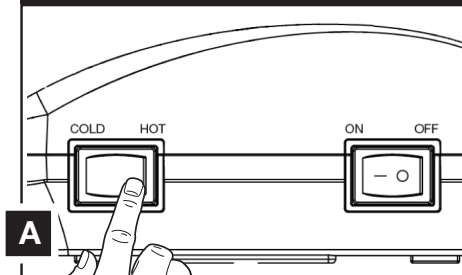

Introduction



Thank you for choosing this Laminator from GBC. We are sure it will serve you well, but please take a little time to read these instructions to ensure you get the best out of your machine.

Your new laminator may emit a slight odour during the initial stage of operation. It is normal and will diminish after several hours of operation.

Technical Specifications

Inspire™ Plus A4

| | |
|-------------------------|--------------------------------------------------------------------------------------------|
| Electrical | EU: 220-240V~ 50/60Hz / 295W / 1.35A KR: 220-240V~ 50/60Hz / 275W / 1.25A |
| Machine Dimensions | W350 x D147 x H65 mm |
| Machine Weight | 1 kg |
| Maximum Pouch Width | 230 mm |
| Maximum Pouch Thickness | 2 x 100 micron (Total 200) |
| Maximum Thru-put | 0.5 mm |
| Warm-Up Time | 3 - 5 minutes |
| Speed | 230 mm per minute |

Inspire™ Plus A3

| | |
|-------------------------|-----------------------------------------------------------------------------------------|
| Electrical | EU: 220-240V~ 50/60Hz 400W / 1.85A KR: 220-240V~ 50/60Hz / 375W / 1.7A |
| Machine Dimensions | W440 x D147 x H65 mm |
| Machine Weight | 1.6 kg |
| Maximum Pouch Width | 330 mm |
| Maximum Pouch Thickness | 2 x 100 micron (Total 200) |
| Maximum Thru-put | 0.5 mm |
| Warm-Up Time | 4 - 6 minutes |
| Speed | 230 mm per minute |



Points to Note



SAFETY FIRST



Please read and keep these important safety instructions

Your safety as well as the safety of others is important to ACCO Brands. In this instruction manual and on the product are important safety messages. Read these messages carefully.



THE SAFETY ALERT SYMBOL PRECEDES EACH SAFETY MESSAGE IN THIS INSTRUCTION MANUAL.

THIS SYMBOL INDICATES A POTENTIAL PERSONAL SAFETY HAZARD THAT COULD HURT YOU OR OTHERS, AS WELL AS CAUSE PRODUCT DAMAGE OR PROPERTY DAMAGE.

- Only use the unit for its intended purpose.
- Do not touch the heating plate of this unit as it may be hot.
- The unit must only be connected to a supply voltage corresponding to the electrical rating shown on the unit.
- Unit should be connected to a socket outlet near the equipment that is easily accessible.
- Do not connect to multi adaptors or use with an extension cable.
- Never push objects through the housing slots. Do not spill liquid of any kind on this product.
- Close supervision is required when this product is used near children.
- Failure to follow these instructions could result in damage/injury and will invalidate your guarantee.
- Do not attempt to service or repair the unit yourself.
- In the event of a fault, unplug the unit and contact an authorised GBC service representative for any required repairs.
- Do not use this unit if the cable or plug have been damaged.

Operation, hot lamination

- ❶ Connect power cord to appropriate power source.
- ❷ To use the laminator (fig. A):

For Plus A4: Switch the temperature button to “HOT” position and the power button to “ON” (I) position. The power indicator will glow.

For Plus A3: Switch the power button to “HOT” (II) position. The power indicator will glow.
- ❸ Position the document to be laminated into a GBC laminating pouch, so that the document is aligned to the folded sealed edge and the right and left borders are equal (fig. B).
- ❹ When the ready indicator glows (fig. C), insert pouch with the sealed edge first into the machine (fig. D).
- ❺ The laminated item will automatically exit rear of the machine. After the pouch has stopped moving, immediately place it on a flat surface to cool for one minute before handling.
- ❻ If you have finished laminating, switch the power button to “OFF” (O) position (fig. A).



NOTE: DO NOT LAMINATE AN EMPTY POUCH.

Operation, cold lamination

- ❶ Connect power cord to appropriate power source.
- ❷ To use the laminator (fig. A):

For Plus A4: Switch the temperature button to “COLD” position and the power button to “ON” (I) position. The power and ready indicator will glow.

For Plus A3: Switch the power button to “COLD” (II) position. The power and ready indicator will glow.
- ❸ Use and laminate your cold pouch.



CAUTION: IF YOU HAVE JUST DONE HOT LAMINATION, PLEASE WAIT AT LEAST 30 MINUTES FOR THE MACHINE TO COOL DOWN BEFORE ATTEMPTING TO DO COLD LAMINATION.

Release Button

In the event of a misfeed or a jam follow these instructions.

- ❶ Turn off the laminator immediately.
- ❷ Press the release button to release the motor from the rollers. Pull out your document from the front of the laminator while pressing the release button left. (fig. E).
- ❸ Clean the rollers as described in the cleaning section. The laminator will be ready to use again within seconds.



NOTE: DO NOT LAMINATE AN EMPTY POUCH.



CAUTION: BE CAREFUL WHEN REMOVING THE LAMINATED POUCH FROM THE MACHINE. IT MAY BE HOT.

Cleaning



WARNING: UNPLUG THIS PRODUCT BEFORE CLEANING THE EXTERIOR. WIPE EXTERIOR ONLY WITH A DAMP CLOTH AND DO NOT USE DETERGENTS OR SOLVENTS.

Adhesive may exit the pouch and stick to the rollers while laminating or if a jam occurs. Regularly feed a cleaning card or sheet of paper through the laminator to clean the rollers.

- ❶ Run the cleaning card or sheet of paper through the machine two or three times.
- ❷ Turn off the machine when finished laminating and cleaning.

Laminating Tips

- **DO NOT LAMINATE AN EMPTY POUCH.**
- Never insert the loose end of the pouch into the machine first. This could cause the machine to jam.
- Before laminating important or unique documents, always run a test pouch through the laminator using a similar type of document.
- Do not attempt to do single sided lamination. This will destroy the laminator.
- As soon as hot lamination is completed, remove the lamination from the front of the machine and place on a cool flat surface for cooling to prevent the pouch from curling.
- Do not block the vent slots, this will cause the laminator to overheat.
- Do not cut pouches prior to lamination.

Service

Do not attempt to service or repair the pouch laminator yourself. Unplug the unit and contact an authorised ACCO Brands service representative for any required repairs.

Guarantee

Operation of this machine is guaranteed for two years from date of purchase, subject to normal use. Within the guarantee period, ACCO Brands will at its own discretion either repair or replace the defective machine free of charge. Defects due to misuse or use for inappropriate purposes are not covered under the guarantee. Proof of date of purchase will be required. Repairs or alterations made by persons not authorised by ACCO Brands will invalidate the guarantee. It is our aim to ensure that our products perform to the specifications stated. This guarantee does not affect the legal rights which consumers have under applicable national legislation governing the sale of goods.

产品简介



感谢您选择GBC塑封机，我们相信它会为您服务好。请花点时间阅读本使用说明书以确保机器可以最大限度地发挥作用。

新机在最初使用时可能会有一点气味，这是正常的现象，气味会在机器使用数小时后消失。

规格参数

Inspire™ Plus A4

| | |
|--------------|--------------------------------------------------------------------------------------------------------|
| 电气规格 | EU: 220-240V~ 50/60Hz / 295W / 1.35A KR: 220-240V~ 50/60Hz / 275W / 1.25A |
| 机器尺寸 (毫米) | W350 x D147 x H65 |
| 机器重量 (公斤) | 1 kg |
| 塑封膜最大幅度 | 230 mm |
| 塑封膜最大厚度 (微米) | 2 x 100 (Total 200) |
| 塑封件最大厚度 (毫米) | 0.5 mm |
| 预热时间 (分钟) | 3 - 5 minutes |
| 塑封速度 (毫米/分钟) | 230 mm per minute |

Inspire™ Plus A3

| | |
|--------------|-------------------------------------------------------------------------------------------------------|
| 电气规格 | EU: 220-240V~ 50/60Hz / 400W / 1.85A KR: 220-240V~ 50/60Hz / 375W / 1.7A |
| 机器尺寸 (毫米) | W440 x D147 x H65 |
| 机器重量 (公斤) | 1.6 kg |
| 塑封膜最大幅度 | 330 mm |
| 塑封膜最大厚度 (微米) | 2 x 100 (Total 200) |
| 塑封件最大厚度 (毫米) | 0.5 mm |
| 预热时间 (分钟) | 4 - 6 minutes |
| 塑封速度 (毫米/分钟) | 230 mm per minute |

警告



安全第一



在使用产品之前，请务必遵循以下的安全规定，以免发生意外伤害。

您和他人的安全对于爱珂品牌公司非常重要。本使用说明书内以及产品上有重要的安全信息，务请仔细阅读。



警示标志会出现在本使用说明书内每条安全信息之前。

这个警示标志表示潜在的对您或他人的人身安全危险，以及造成产品损坏或财产损失的危险。

- 请确保只能将本机用于预定用途。
- 请勿触摸本机的加热板，因为它可能很烫。
- 请确保设备只能连接到与设备上显示的电气规格。
- 请确保插座就近放置并且易于插拔。
- 请确保电器插座不会过载，否则会有发生火灾或者触电的风险。
- 绝不能用任何物件去压本机外壳上的槽缝。禁止往机器上泼洒任何液体。
- 产品使用过程中，如有儿童在场，请务必严密监控。
- 不遵守这些说明可能导致损坏/伤害，并使保证失效。
- 请勿自行维修，否则会导致保修条款失效。产品遇有故障，请联系供货商。
- 如果发生故障，请拔下设备插头，并联系授权的GBC维修服务人员进行必要的维修。
- 如有电源线或插头损坏时，请勿使用产品。

操作：热封

- ① 将电源插头连接上适当的电源。
- ② 启动塑封机（见图 A）：
Plus A4：将温度开关拨至“HOT”档，将电源开关拨至“ON”（I），电源指示灯亮起。
Plus A3：将开关拨至“HOT”（II）档，电源指示灯亮起。
- ③ 将文件用GBC塑封膜装好：上下方向同塑封膜的封边齐平，左右方向同塑封膜的两端对齐（见图 B）。
- ④ 当待机指示灯亮起（见图 C），将封边塞入塑封入口（见图 D）。
- ⑤ 塑封品会自动从机器后部的塑封出口出来。当塑封膜停止移动，请立即将塑封品置于平坦表面冷却一分钟。
- ⑥ 塑封完成之后，请将电源开关拨至“OFF”（O）档（见图 A）。



注意：请勿塑封空的塑封膜。

操作：冷裱

- ① 将电源插头连接上适当的电源。
- ② 启动塑封机（见图 A）：
Plus A4：将温度开关拨至“COLD”档，将电源开关拨至“ON”（I），电源指示灯亮起。
Plus A3：将开关拨至“COLD”档，电源指示灯亮起。
- ③ 开始冷裱。



警告：如果刚完成热封，请至少等待30分钟。等机器冷却下来之后再冷裱。

清除卡纸

如果文件放入不当或者发生堵卡，请按以下指示清理：

- ① 立即将机器的电源关闭。
- ② 按下清除卡纸开关，电机反转。按住清除卡纸开关（见图 E）的同时，将文件从塑封机前部拔出来。
- ③ 按照下文清理辊轮的要求，把辊轮清理干净。
- ④ 塑封机恢复工作状态。



警告：当拔出塑封文件的时候请务必当心，塑封膜可能会烫手。

清理清洁



警告：清洁塑封机外壳前，请务必先拔掉塑封机的电源插头。仅可使用湿布擦拭外壳，请勿使用洗涤剂或其它溶剂。

塑封过程中或出现堵卡时，塑封膜上的胶质可能会粘到滚轮上面。请定期使用一张清洁卡片或者一张白纸，模拟塑封过程，以达到清理辊轮的目的：

- ① 拿一张清洁卡片或者一张白纸，模拟塑封过程两到三次。
- ② 完成后请关闭机器的电源。

塑封小贴士

- 请勿塑封空的塑封膜。
- 请勿将塑封膜的开口部分塞入塑封入口，这将导致堵卡。
- 在塑封重要文件之前，请用类似尺寸/材质的文件先试机。
- 请勿尝试单面塑封，这会导致塑封机彻底损坏。
- 热封一旦完成，请将塑封品拿出并放置于室温下的平坦表面以待冷却，这样可以避免塑封膜卷边。
- 请勿堵住机器的散热槽，以免塑封机过热。
- 塑封前请勿裁剪塑封膜。

维修服务

请勿尝试自行修理。如果机器需要维修，请拔下电源插头，联系爱珂品牌公司授权服务商。

保证

本机保证自购买之日起一年内正常使用。在保证期内，ACCO Brands 将根据其选择应维修或更换本保修协议覆盖的缺陷件。为了保证本保修协议的效力，您必须按照本保修协议附带的说明书中的规定操作和使用产品。因意外、误用、滥用或疏忽造成的任何损坏，不在本保修协议的范围内。请保留标有日期的销售收据作为购买日期的证据。未经ACCO Brands 授权的人员进行维修或更换将使担保失效。我们的目标是确保我们的产品达到规定的规格。本保修协议不影响您依法享有的任何其他法律权利。

产品保修证书

No. 231018

仅适用于中国大陆地区 (不包含港澳台地区)

产品型号: _____

机身编号: _____

保修期 : 购买之日起一年 _____



重要信息：如果您的器材需要我们的维修服务，请出示本保修证书连同购买证明 (如销售发票，收据等)。保修期后提供的所有维修服务将收费。

产品保修条款

ACCO特此保证供应的产品, 无论设计, 材料和做工, 无任何缺陷。在保修期内 (从购买之日起十二 (12) 个月), 在正常使用过程中, 如果出现任何缺陷, ACCO应当按其绝对酌情权, 提供免费维修或更换故障机器部件。

1. 本保修不得转他人使用否则保修将作废。
2. 本保修应在下列情况下被视为无效：
 - a. 机身编号标签已被更改, 损坏或去除。
 - b. 由于使用者之过失或操作错误以致故障或损坏。
 - c. 本机并没有按照说明书中给出的指示安装或操作。
 - d. 未经允许自行维修或改装以致故障或损坏。
 - e. 未经允许私自拆装以致故障或损坏。
3. 本保修只适用于中国大陆地区 (不包含港澳台地区) 销售的产品。
4. 本保修不包括由产品正常磨损或撕裂导致的故障或缺陷。
5. ACCO保留不给予任何事先通知的情况下, 修订或修改本保修条款的权利。



广州市爱珂贸易有限公司上海分公司
中国上海市长宁区
延安西路2299号1509室
电话：021-61368966
传真：021-61710161
www.accobrand.cn

Certificate of Warranty

(For use in Singapore only)

No. 231018

Model : _____

Serial No. : _____

Validity : 2 years from date of purchase _____



IMPORTANT: Certificate of Warranty must be produced together with proof of purchase (e.g. sales invoice, receipts, etc) when your equipment requires our service. All services provided after warranty period will be chargeable.

Terms and conditions

ACCO Brands Asia hereby certify that all machines of whatever designs are free from any defects in materials and in workmanship under normal use and service for twenty four (24) months from date of purchase. Should any defects occur within the aforesaid period, ACCO Brands Asia shall at their absolute discretion, effect repairs or replacement of any part of the said machine free of costs.

1. This warranty shall not be transferable, negotiable or assignable to any third party.
2. This warranty shall be considered VOID under the following circumstances:
 - a. The serial number of the machine has been altered or removed.
 - b. The machine has been subjected to misuse, accident, and negligence.
 - c. The machine has not been installed, maintained or operated in accordance with the instructions given in the instruction manual.
 - d. The machine has undergone repairs, adjustments or corrections made to it by unauthorised person.
 - e. The machine has been dismantled by unauthorised person.
3. This warranty is applicable only in Singapore.
4. This warranty shall exclude all faults/defects caused by natural wear and tear.
5. This warranty shall exclude all other warranties & guarantees, expressed or implied other than mentioned above.
6. No notices will be given on expiry of this warranty. ACCO Brands Asia reserves the rights to amend or modify the terms and conditions of this warranty without giving any prior notice.



ACCO BRANDS ASIA PTE LTD

5A Toh Guan Road East

#06-03 Singapore 608830

Tel: +65 6776 0195

Fax: +65 6779 1041

singapore.webmaster@acco.com